

ENI-VIBE® MODEL 33VC4400B

Operating Guides can be located on the Enidine B2B website at: b2b.itcontroltech.com

ENI-VIBE™ Configuration:

Refer to the Operating Guide for comprehensive instructions for various scenarios. One scenario is outlined below:

1. Before data recording can begin, a configuration file must be created on the Micro-SD® card. To create the configuration file, insert the Micro-SD® card into PC via Micro-SD® card slot or external Micro-SD® card device reader, open the Eni-Vibe™ Analysis Software Toolkit and select the **SD card drive**.

a. Open the Eni-Vibe™ software and click the **Create Configuration File** tab

b. Go to the File Explorer window and locate the **SD Card Drive**. Click  and navigate to the Eni-Vibe™ drive. Click **Select Folder**.

c. Click  and the formatting confirmation window will appear (See image on the right) Click **OK**.

***NOTE:** For the purposes of this quick start guide, default setting values will be used. For details on selecting different value settings, refer to the Operating Guide.*

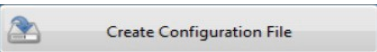

d. Click  at the bottom of the screen and select **Current Folder**. You can verify the presence of the configuration file by opening your File Explorer window; it will be listed in the Eni-Vibe™ drive.

2. After creating the configuration file, remove the Micro-SD® card and insert into the Eni-Vibe™ device

***NOTE:** Ensure the Eni-Vibe™ is powered off before inserting Micro-SD® card to avoid file corruption.*

ENI-VIBE™ Data Collection:

1. To turn on the device, press the **Power** button
2. The **Check/Ready** light will blink to indicate the presence of the Micro-SD® card and the configuration file that was just created
3. Once the device is satisfied with setup requirements, the **Recording Status** is ready when the light turns green shortly after the Check/Ready light flashes.

***NOTE:** If Recording Status is not working, refer to the Operating Guide for troubleshooting*

a. To start recording, press the **Record** button. The **Recording Status** light will turn orange.

4. To stop recording, press the **Record** button again

5. The device will then save the current file and the **Recording Status** light will turn green to indicate that the device is ready to record the next file

6. To turn off the device, press the **Power** button

ENI-VIBE™ Data Transfer to Enidine:

1. To view the data, eject the Micro-SD® card from the device and insert into the computer.

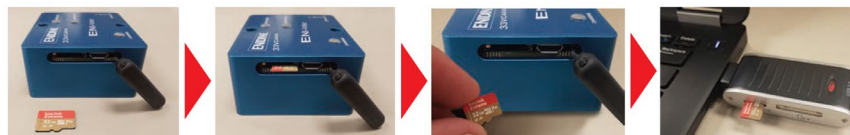

2. Open the folder, drag and drop the data file into an email, and send to industrialsales@enidine.com.